

Explosion Proof High Speed Dome Camera

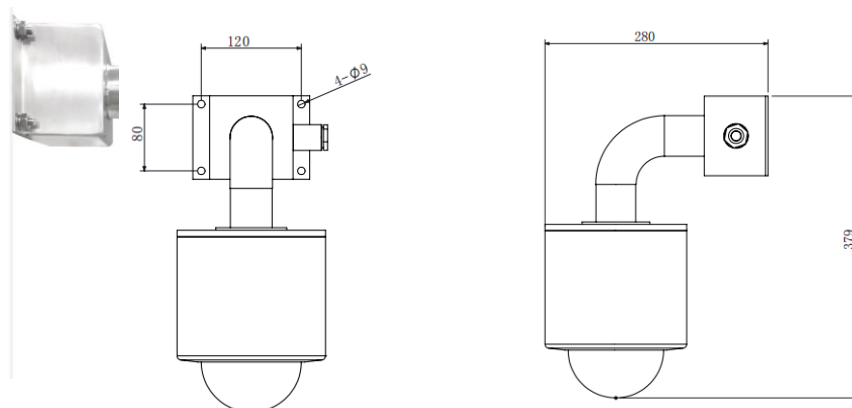

Manufacturing Standards:

GB3836.1-2000 "Electrical Equipment for Explosive Gas Atmospheres Part 1: General Requirements"

GB3836.2-2000 "Electrical Equipment for Explosive Gas Atmospheres Part 2: Flameproof Type "d""

GB 12476.1-2000 "Electrical Equipment for Combustible Dust Environments Part 1: Electrical Equipment Protected by Enclosures and Limiting Surface Temperatures"

Features:

- Highly integrated explosion-proof pan/tilt, explosion-proof infrared camera, explosion-proof decoder, smaller and lighter, more intelligent and advanced functions;
- 2.0MP high-definition integrated movement, 26X optical Zoom, 12X Digital Zoom.
- Applicable to dangerous and harsh environments where various flammable gases or dust exist, double side load structure design, can be used with auxiliary lighting equipment such as cameras and fill lights.
- Using 304 stainless steel material, integrated and simple design, the window is made of tempered glass coated with waterproof film on both sides, which is impact-resistant and has

It has good shielding and cooling effect. Explosion-proof, dust-proof, waterproof, rust-proof

- 360° horizontal rotation, -90°~+90° vertical movement, all-round monitoring of suspicious targets.
- Pelco-D/Pelco-P protocol adaptive, RS422/485 communication mode.
- RS-485 control function, compatible with various communication protocols and communication rates, can accurately and quickly respond to various host instructions;
- Optical-grade high-strength and high-transmittance ultra-white explosion-proof glass, with a luminous flux rate higher than