

Explosion proof Housing camera

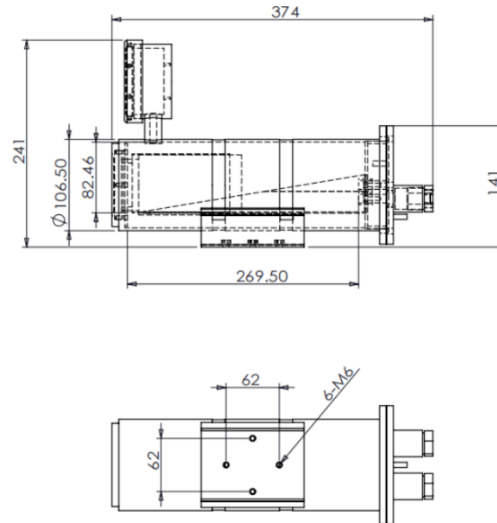

Functional characteristics

- double explosion proof certification, explosion proof mark: Ex d IIC T6Gb/Ex tD A21IP68T80°C
- resolution 1920*1080P
- support H264 and H265 video compression algorithms;
- visible light uses a high-performance 2 million pixel 1/2.8" CMOS image sensor ,26X Zoom
- IP68,Explosion-proof,anti-corrosion,dust-proof and waterproof
- Work Temperature: -30°C~+60°C
- 50M IR Distance
- 304 Stainless steel / 316L Stainless steel.

Environment

Suitable for flammable gases with class II A、IIB、IIC, ignition temperature group is zone 1 and zone 2 of T1-T6 group, flammable explosive gas, dust, oil refining, refining, gas station, filling station, oil well, drilling, oil tank truck, pipeline valve station, etc. The mixture of gas, steam or foggy combustible substance and air in explosive gas environment atmosphere will spread all over the environment of un-burned mixture after igniting in the mixture.

Technical parameters

Model	HL-814D-W-1080P
Mark of Explosion-proof	ExdIICT6Gb/ExtD A21 IP68 T80°C
Material	Stainless steel 304./316L optional
Grade of Explosion-proof	IP68
Camera	
Sensor	1/2.8" CMOS sensor
Effective pixels	2.0MP(1920*1080)
Day&Night	AUTO Starlight
White balance	Auto/manual
Min Lux	0.01Lux (Color) 、0.001Lux (B&W)
BLC	Off/low/middle/high/very high
HLC	Support
WDR Range	100dB
DNR	3DNR
SNR	≥50dB
Video Compression format	H.265 Main Profile / H.264 High profile / M-JPEG
Network Interface	1ch 10/100Base Ethernet, RJ45
Network Protocol	TCP/IP, HTTP, NTP, IGMP, DHCP, UDP, SMTP, RTP, RTSP, ARP, DDNS, DNS, HTTPS, P2P
ONVIF	Standard ONVIF2.4
Privacy protection	4 Area per picture
Day&Night	Auto ,Fixed B&W,Fixed Color,External control
Auto Mode	Support 4 automatic cruise,4Automatic cruise trace,4Automatic line sweep
Main Stream	1920x1080、1280x960、1280x720、720x576、640x480
Sub Stream	640x480、352x288、320x240、176x144
Output Stream rate	32Kbps~10Mbps
User	3 view at the same time
IR Distance	50M

Lens	
Megapixel	2.0Megapixel
Day/Night	Yes(with IR CUT filter)
Lens Type	26X Zoom
General	
Outside Dimension	340*130mm
Inside Dimension	280*100mm
Weight	8kg
The outlet hole number	2
Cable entry's screw spec	M25x1.5
Power Supply	DC 12V; 2A
Working Temperature	-30°C~+60°C
Wiper	Invisible wiper, Nanometer Material